

# 2.00mm Female Header DIP Type

## SPECIFICATION

**Current Rating** :2.0AMP  
**Insulation Resistance** :1000M  $\Omega$  MIN.  
**Contact Resistance** :20m  $\Omega$  MAX.  
**Withstanding voltage** : AC 500V MIN.  
**Operating Temperature** :-40  $^{\circ}$ C to +105  $^{\circ}$ C

**Contact Material** :Copper Alloy  
**Contact Plating** :Gold or Tin over Nickel  
**Insulation Material** :PA9T+30%G.F UL94V-0  
**Color** :Black

**AFE43**    **X**                    **R**    -    **001**    -    **XX**                    **XX**                    **X**                    **X**

Row Type:  
 1=Single Row  
 2=Double Row

No.of Pins  
 Per Row:  
 02 thru 40

**Contact Plating:**  
 G1=Full gold flash    G3=Full gold 3u"  
 G5=Full gold 5u"    G6=Full gold 10u"  
 G7=Full gold 15u"    G8=Full gold 30u"  
 K1=Gold flash on contact, Tin 100u" on tail  
 K5=Gold 5u" on contact, Tin 100u" on tail  
 K6=Gold 15u" on contact, Tin 100u" on tail  
 K8=Gold 30u" on contact, Tin 100u" on tail  
 S1=Full Tin 100u"

**Insulation Material:**  
 B=PBT  
 D=LCP  
 F=PA9T  
 H=PA6T

**Packing:**  
 Y=Tray  
 T=Tube  
 P=PE Bag

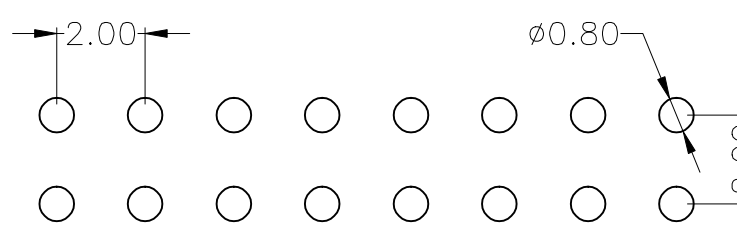
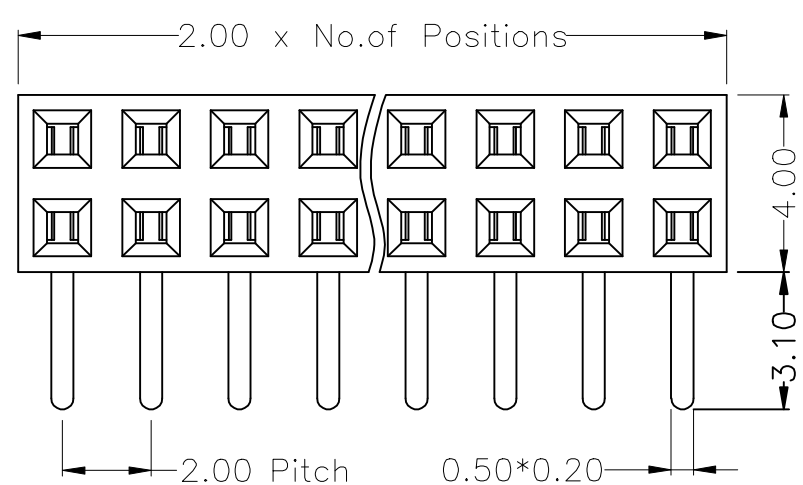
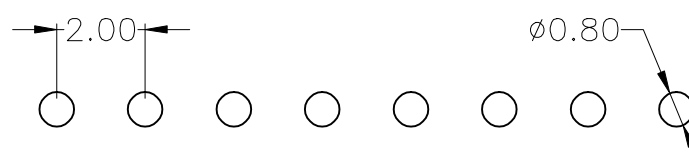
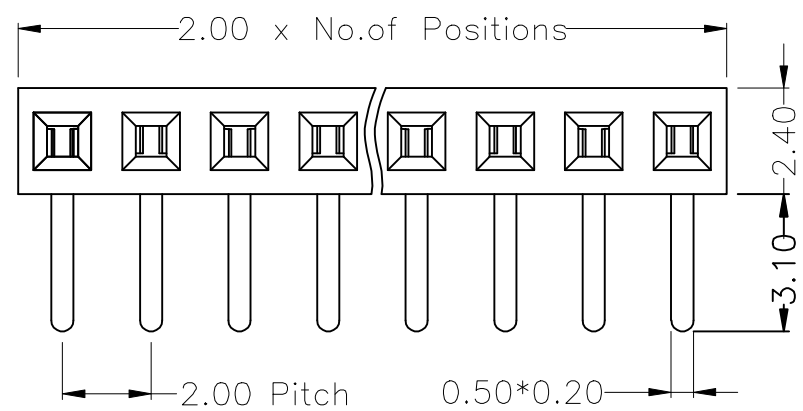

Recommended P.C.B. Layout

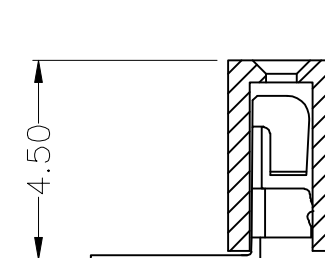
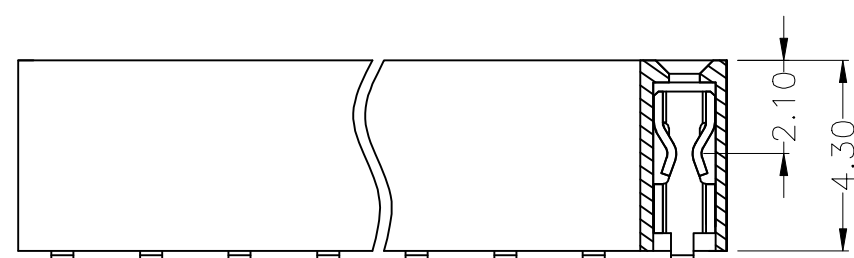

AFE431R

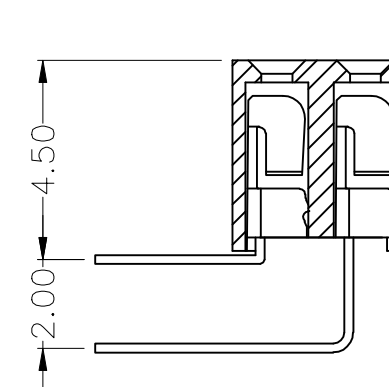

AFE432R